

Installation Guide

S12-410 Sliding Door Lock Set with Key Lock

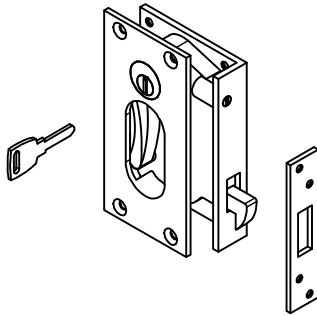

Required Materials (not included)

- Safety glasses
- Masking tape
- Measuring tape
- Pencil
- Hole Saw
- Jigsaw
- Router
- Drill and bits
- Screwdriver
- 12X - #8 X 3/4" long flat head stainless screws

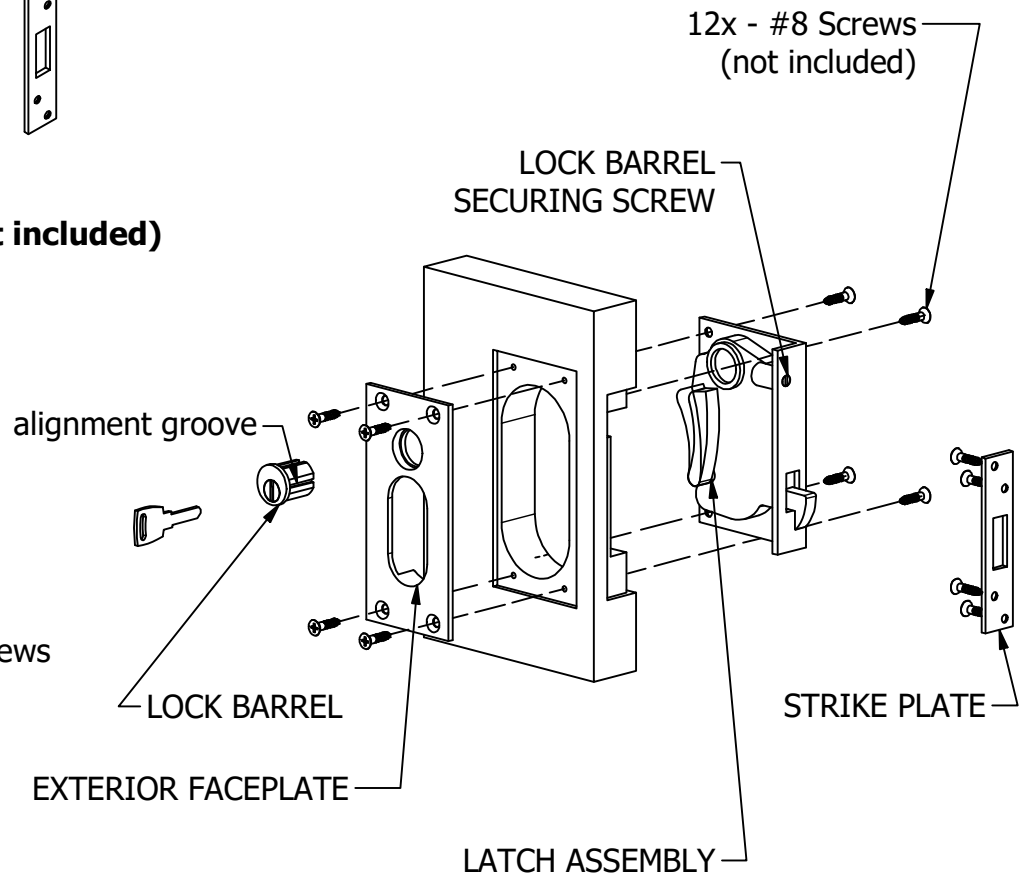

Instructions

1. This latch is designed for use with 1-1/4" thick sliding doors. Left hand opening only. The hook striker should face down.
2. Cover work surface using masking tape and use template to mark cutout locations. Position template and cutout center oval first followed by the remainder of the Latch Assembly side.
3. Tip: Before cutting the Exterior Faceplate side, test fit the Latch Assembly and Exterior Faceplate into door. Check alignment by threading the lock barrel into position. The perimeter of the Exterior Faceplate should match the marked cutout location.
4. Make cutout on Exterior Faceplate side of door.
5. Assemble complete latch assembly and mark fastener holes using the latch as a template. Predrill fastener holes. **Use caution with carbon steel tools around stainless hardware. Surface contamination can lead to the appearance of rust.**
6. Install 8X #8 X 3/4" screws to secure the Latch Assembly and Exterior Faceplate.
7. Thread the Lock Barrel into its final position. The face of the barrel should be flush with the surface and key opening positioned at the bottom. Gently tighten the Lock Barrel Securing Screw while wiggling the Lock Barrel until the screw fits securely into the alignment groove. A thread locking compound may be used to prevent loosening of the Barrel Securing Screw.
8. Position Strike Plate on door jamb. Use the Strike Plate as a template to mark the location of latch hook cutout. Tip: Use hook striker to help locate the Strike Plate by closing the door until it marks the door jamb.
9. Make cutout and predrill holes. Install Strike Plate using 4X #8 X 3/4" screws.
10. Wipe down all metal surfaces using Stainless Steel polish/protectant.

Installation Guide

S12-410 Sliding Door Lock Set with Key Lock



WHITE WATER
MARINE HARDWARE

